

# UHF 2710 INLAY

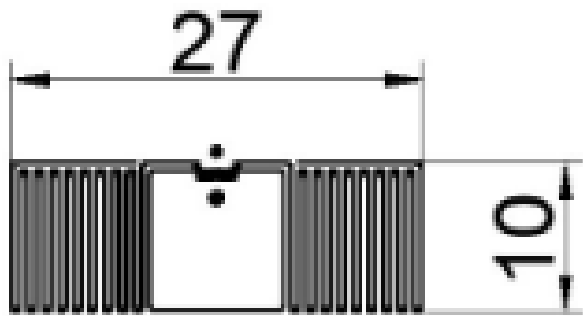

Global Tag **UHF 2710** is a RFID UHF antenna design with small size and compact form, which has been designed for production control operations and for projects which require a moderate reading distance to avoid false positives. This product can be supplied in the form of wet-inlay, paper label, PET/PP label. Different customizations are available such as die-cut label size, encoding of EPC/memory and barcode/QR/text printing.



## MECHANICAL AND ENVIRONMENTAL SPECIFICATIONS

**Antenna Size:** 27x10mm

**Wet inlay size:** 30x13mm

**Paper/PP/PET label size:** 30x13mm

**Pitch Size:** 16mm

**Gap:** 3mm

**Web Width:** 40mm

**Mounting System:** Glue, (optionally 3M 467 adhesive or Removable Glue)

**Antenna Material:** Aluminum

**Storage Temperature:** +10°C to +35°C (sealed in the vacuum bag and avoid direct sunlight exposure)

**Storage Humidity:** 30% to 70% RH (sealed in the vacuum bag and avoid direct sunlight exposure)

**After gluing Temperature:** -20°C to +50°C

**After gluing Humidity:** 20% to +80% RH

**Delivery format:** in reel

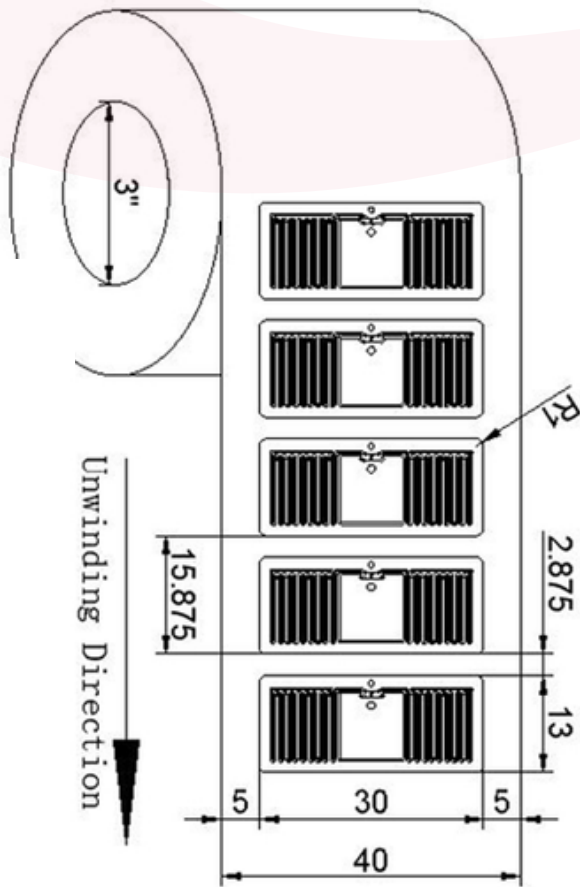

### IC CHIP SPECIFICATION:

|                        |                       |
|------------------------|-----------------------|
| Operation Frequency    | UHF 860-960 Mhz       |
| Air interface protocol | UHF EPC Class 1 Gen 2 |
| IC Type Available      | NXP U-Code 8          |
| TID Memory             | 96bit                 |
| EPC Memory             | 128bit                |
| User Memory            | -                     |

### READING DISTANCE:

**With long range fixed reader:** ----- EU frequency 0 ~ 4m (2W ERP) -----  
 US frequency 0 ~ 3,5m (4W EIRP)

### INSTALLATION MODE:

**With permanent strong glue:** when mounting the tag with adhesive background, clean and dry the surface to obtain the maximum bond strength. The range temperature must be +10°C to +40°C and humidity range 20% to +80% RH

## **CUSTOMIZATION OPTIONS:**

**Printing:** 4-color or monochrome logo, Progressive number, Serial number from database, Barcode or QRCode

**Encoding:** Writing contents in EPC/User Memory (optionally from customer's database)

**3M glue:** According to the project requirement and basing on the surface material we can supply special adhesive

## **ORDER INFORMATION:**

**Standard products have these available size**

**PRODUCT CODE WET-INLAY:** GT-WT3013-U8

**PRODUCT CODE PAPER LABEL:** GT-PL3013-U8

**PRODUCT CODE PET LABEL:** GT-PET3013-U8

**PRODUCT CODE PP LABEL:** GT-PP3013-U8

**For further information or customized request:**

**Global Tag Srl – Via Zanardelli 13/A 25062 Concesio (BS) - Italy**

**P** +39 030 2005259

**S** global-tag

**W** www.global-tag.com

**M** sales@global-tag.com

## **DISCLAIMER:**

The information in this document is subject to change without notice. Global Tag assumes no responsibility for any errors that may appear in this document. Application recommendations are guidelines only - actual results may vary and should be confirmed. This is a general-purpose product not designed or intended for any specific application. Global Tag Srl or its subsidiaries are not responsible for the performance or support of third party products and does not make any representations or warranties whatsoever regarding quality, reliability, functionality, or compatibility of these devices or products.