

20M LONG RANGE ON METAL TAG



Global Tag **20M LONG RANGE ON-METAL TAG** has been developed for indoor and outdoor applications requiring reliable identification on metal surfaces, ensuring stable reading performance in industrial environments.

The tag can be mounted on different types of surfaces, while its performance is optimized when applied on metal, where it guarantees consistent and reliable reading even in challenging conditions.

Thanks to its robust design, the tag is suitable for applications requiring durability and efficient asset tracking in industrial environments such as warehouses and production areas.

Different customizations are available, such as color options and encoding, allowing easy integration into existing tracking and identification systems and processes for industrial and logistics applications.

MECHANICAL AND ENVIRONMENTAL SPECIFICATIONS

Dimensions: 105.0 x 30.0 mm

Thickness: 7.5 mm

Mounting System: Adhesive, screw, binding

Weight: 26.0 g

Material: ABS + PC

Color: White (or others)

Class Protection: IP67

Storage Temperature: -40°C to +85°C

Operating Temperature: -25°C to +85°C

Certifications: Reach Approved, RoHS Approved, CE Approved.

Read Range:

Fixed Reader:

Up to 19.0 m (US 902–928 MHz)

Up to 20.0 m (EU 865–868 MHz)

Handheld Reader:

Up to 7.0 m (US 902–928 MHz)

Up to 7.5 m (EU 865–868 MHz)

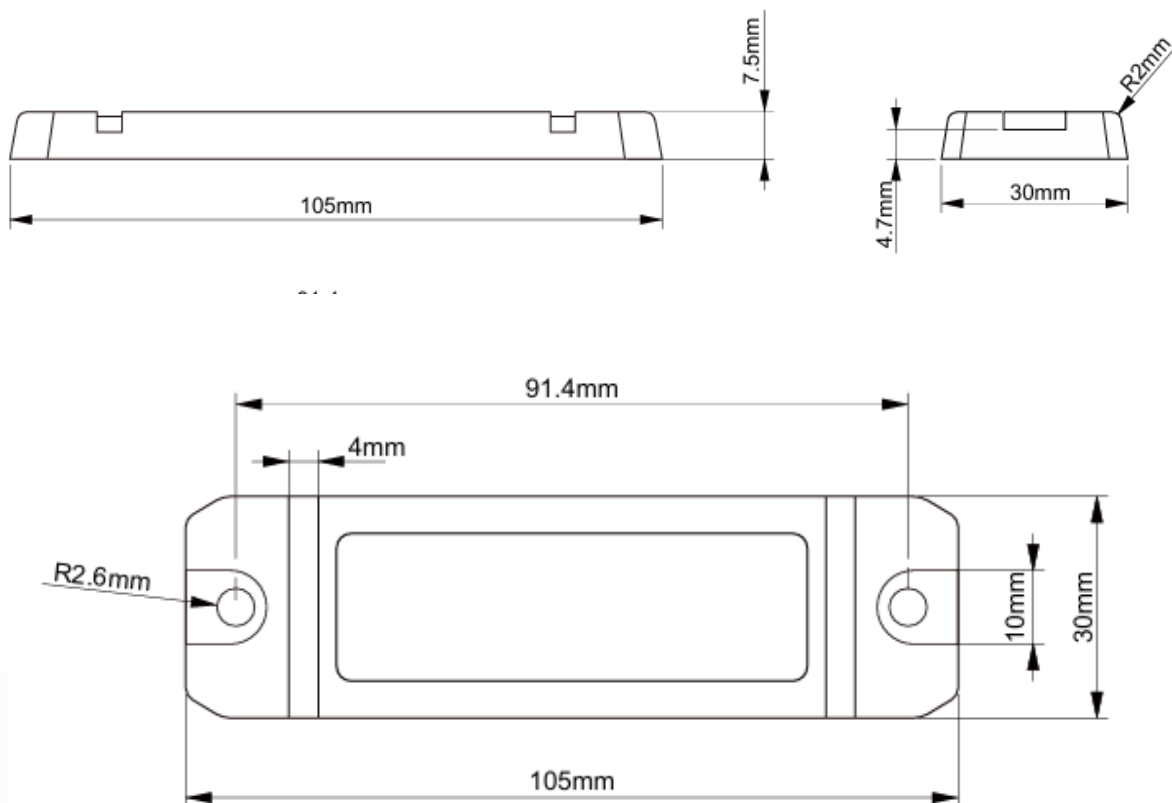

TYPES OF RFID CHIPS:

Frequency: US (902–928 MHz), EU (865–868 MHz)

Device type: EPC Class1 Gen2

Air interface protocol: ISO18000-6C

IC Type Available: NXP UCODE 8

Memory: EPC 128 bits, USER 0 bits, TID 96 bits

Functionality: Read / Write

Write Cycles: Minimum 100,000 times

Data Retention: Up to 50 years

ORDER INFORMATION:

Standard product is made with NXP UCODE 8 chip

PRODUCT CODE: GT-20MLROM-UC8

Contact us for more information:

Global Tag Srl – Via Zanardelli 13/A 25062 Concesio (BS) - Italy

P +39 030 2005259

S global-tag

W www.global-tag.com

M info@global-tag.com

DISCLAIMER:

The information in this document is subject to change without notice. Global Tag assumes no responsibility for any errors that may appear in this document. Application recommendations are guidelines only - actual results may vary and should be confirmed. This is a general-purpose product not designed or intended for any specific application. Global Tag Srl or its subsidiaries are not responsible for the performance or support of third party products and does not make any representations or warranties whatsoever regarding quality, reliability, functionality, or compatibility of these devices or products.